



CREATING A TEAM USING A TEMPLATE

In Microsoft Teams, you'll join or create an organization made up of various teams. Each team can have different settings with different channels (e.g., General, Project Documentation) to allow project team members in those teams to chat through voice, text, or video, as well as share and collaborate on files.

You can create a team in the Microsoft Teams desktop app or in the web app using the same steps.

1. From the Teams section, click on **Join or create a team** in the bottom lefthand corner of the application.

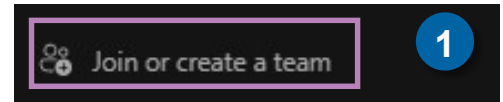

2. From the list of options, select **Create a team** to proceed.

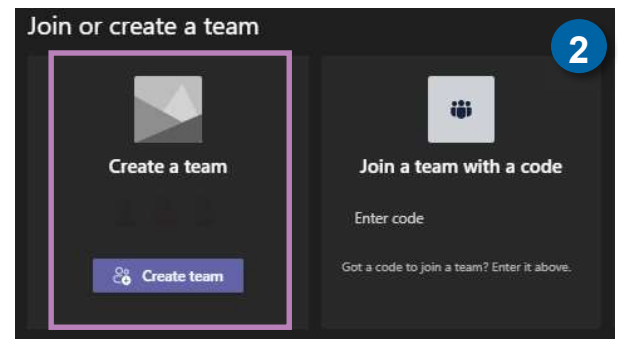

3. From the list of options, select **From a group or team**.

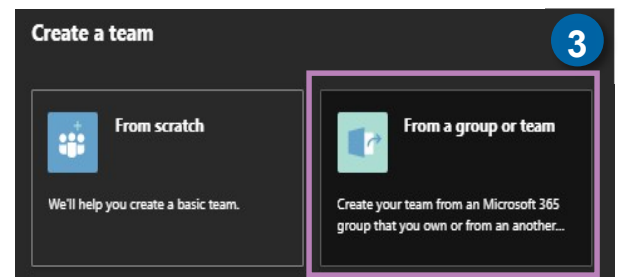

IMPORTANT INFORMATION



QUESTION AND ANSWER REINFORCING TOPIC



FOR YOUR INFORMATION



CREATING A TEAM USING A TEMPLATE

4. From the list of options, select to create a new team from an **existing Microsoft Team**.

5. From the list of options, select **PMO Project Template** to proceed.

6. You will be notified that you are using the “PMO Project Template” as a template for a new team, make sure to update team name below. In the decription, you will need to add both the ARC & RFS numbers associated with the project. Set your team to **Private**, leave checked boxes as is, and select **Create**.

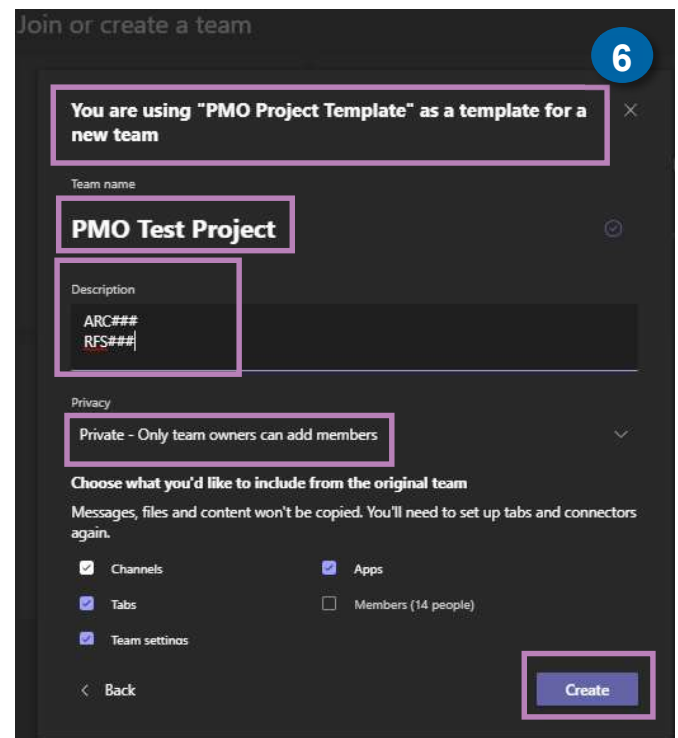
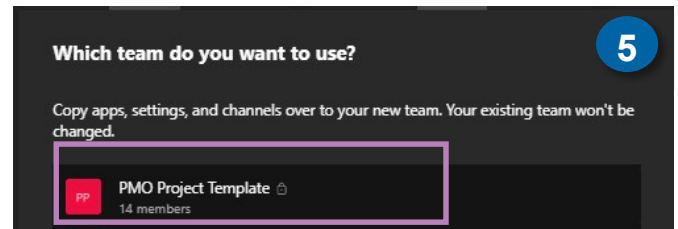
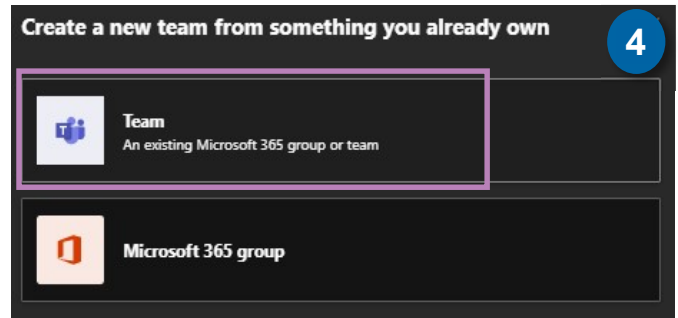

IMPORTANT INFORMATION



QUESTION AND ANSWER REINFORCING TOPIC



FOR YOUR INFORMATION



CREATING A TEAM USING A TEMPLATE

- You will be prompted to add members to your team by typing the name of the associates in the search bar. Once all associates have been found, select **Add**.

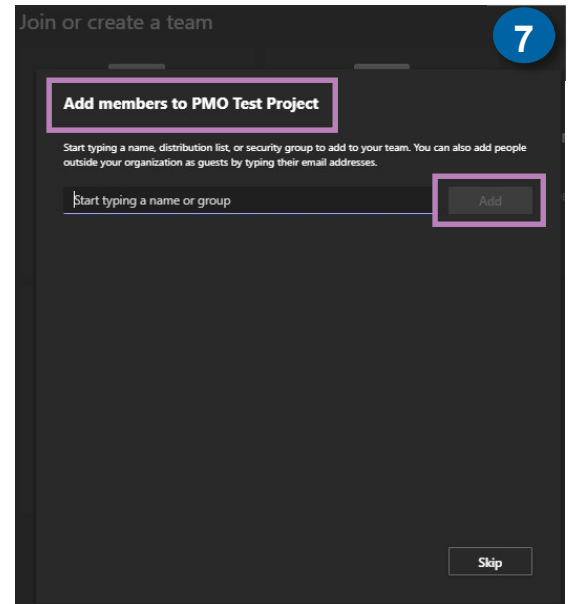

- There will be two channels for each team. **General** will be used for vendor documentation. **Project Documentation** will be used for project related documents.

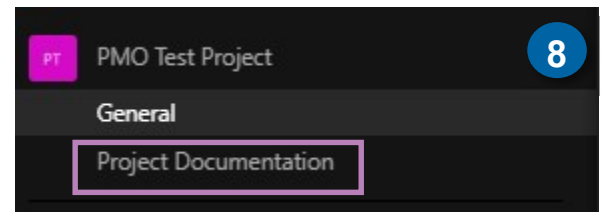

- The **Project Documentation** channel will populate via the template. You will have to go into the files section to create the folder structure that houses the project related documents. **Please follow example to the right.**

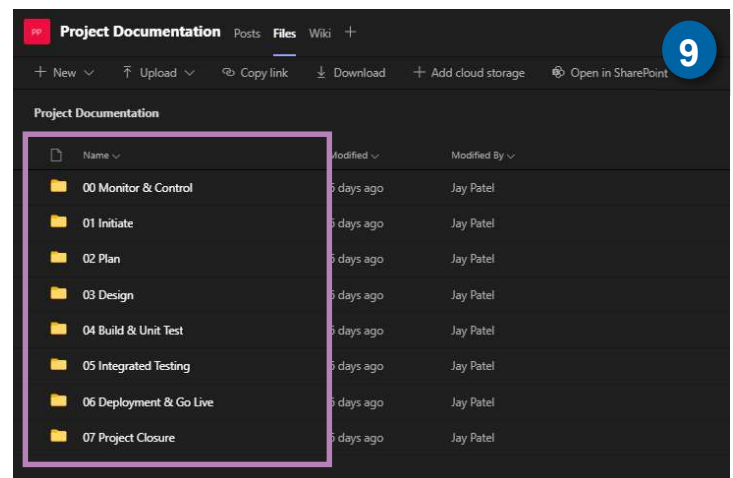

IMPORTANT INFORMATION



QUESTION AND ANSWER REINFORCING TOPIC



FOR YOUR INFORMATION